

GENERAL INFORMATION:
 LOCATION: ROCK PORT HIGH SCHOOL GYM ADDITION
 600 S. NEBRASKA ST. ROCK PORT, MO 64482
 AGENCY INFORMATION: ROCK PORT R-II SCHOOL DISTRICT
 600 S. NEBRASKA ST. ROCK PORT, MO 64482
 RESPONDING FIRE DEPARTMENT: ROCK PORT VOLUNTEER FIRE DEPARTMENT
 AUTHORITY: MISSOURI STATE FIRE MARSHAL'S OFFICE
 JURISDICTION: Department of Facilities Management Missouri State Fire Marshal's Office

PROJECT DESCRIPTION:
 REASON FOR SUBMITTAL: GYM ADDITION
 Pre-engineered metal gym addition to hold 1000 people.

APPLICABLE CODES
 Travels, does MO have something like this?
 2006- International Building Code
 2006- International Mechanical Code
 2005- National Electrical Code
 2009- Uniform Plumbing Code
 2006- International Fire Code

State Law establishes a minimum Life Safety and has a uniform effect throughout the State. KSA 31-133 and KSA 2003 Supp. 31-134 require that all occupied structures conform to the basic life safety requirements.
 A) Existing occupied buildings cannot have hazardous conditions which slow speedy exits.
 B) Alteration of existing buildings cannot make existing conditions worse or block exits.
 C) New construction and changes in use are subject to greater life safety requirements.

OCCUPANCY (Section 303) & STRUCTURAL CLASSIFICATION
 ASSEMBLY (A4)

GENERAL BUILDING LIMITATIONS:
 Construction Type II-B Structural Fire Ratings Table 601
 Structural Frame including columns, girders and trusses: 0 HR
 Bearing exterior walls: 0 HR
 Bearing interior walls: 0 HR
 Nonbearing exterior walls & partitions: 0 HR
 Nonbearing interior walls & partitions: 0 HR
 Floor construction including supporting beams & joists: 0 HR
 Roof construction including supporting beams & joists: 0 HR

ACTIVE LIFE SAFETY SYSTEMS:
 Fire Alarm: Required/Provided:
 FACP: Required/Provided:
 Remote Annunciator Panel: Required/Provided:
 Smoke Detection: Required/Provided:
 MNS: Not Required/Provided:
 Exit Signs: Required/Provided:
 Egress Lighting: Required/Provided:
 Emergency Lights: Diesel Generator
 Backup Power: Required/Provided:
 Suppression- Standpipes: Required/Provided:
 Suppression- Automatic: Required/Provided:

Fire Extinguishers: Required/Provided:

BUILDING 2 HEIGHT AND AREA:
 ACTUAL AREA: 15,300 sq. ft.
 ACTUAL HEIGHT: 1 Story - 30'
 ALLOWABLE AREA: Based on sprinkler increase:
 XX Occupancy XXXXX sq. ft.
 XX Occupancy XXXXX sq. ft.
 XX Occupancy XXXXX sq. ft.

ALLOWABLE HEIGHT:
 X Stories
 XX

PLUMBING FIXTURE COUNT:

Occupancy	Occupant	Water	Lavatory	Drinking	Shower
Type	Load	Closet	Fountain	Fountain	
A - MALE	517	6	2	1	-
A - FEMALE	516	12	3	-	-

Total Required Fixtures: 18 5 1 -
 Total Provided Fixtures: 20 12 2 -

WATER SUPPLY - FLOW TESTS:
 Static: Pending Date:
 Residual: Pending Location:
 Flow: Pending

PASSIVE LIFE SAFETY SYSTEMS:
 Corridor Ratings: Required/Provided: XXXX/XXXX
 Stairwells: Required/Provided: XXXX/XXXX
 Shafts: Required/Provided: 2 Hour
 Occupancy Separations: XXXXXX
 Residential Separations: XXXXXX

CODE SYMBOL LEGEND

SYMBOL	DESCRIPTION	PROTECTIVE ELEMENTS
EXIT	EXIT- EXTERIOR	
EXIT	EXIT- INTERIOR (assembly occ. exit 20 minutes from stairs)	
EXIT	FIRE EXTINGUISHER	
EXIT	FIRE DEPARTMENT CONNECTION	
EXIT	STANDPIPE	
EXIT	HOSE CABINET	
EXIT	HOSE CABINET WITH EXTINGUISHER	
EXIT	FIRE EXTINGUISHER SPACING (Show Radius)	
EXIT	NON-PROTECTED EXIT PATH	None per exception for fully sprinkled A, S, E, F, M, S, A, U Occupancies
EXIT	LIMITED PROTECTION EXIT PATH	Automatic Smoke Detection Throughout Exit Path
EXIT	PROTECTED EXIT PATH (1 Hour Fire Partition wall construction, 20 minute rated door assembly, Fire & Smoke Dampers)	
EXIT	PROTECTED EXIT PATH (2 Hour Fire Partition wall construction, 20 minute rated door assembly, Fire & Smoke Dampers)	
EXIT	SPECIAL COVERAGE	Limited Special Coverage
EXIT	1 HOUR EXIT PASSAGEWAY	1 Hour Fire Barrier wall construction. No openings other than required exit doors. 1 hour door assembly.
EXIT	2 HOUR EXIT PASSAGEWAY	2 Hour Fire Barrier wall construction. No openings other than required exit doors. 1 1/2 hour door assembly.
EXIT	1 HOUR EXIT ENCLOSURE (vertical) (stairwell)	1 Hour Fire Barrier wall construction. No openings other than required exit doors. 1 hour door assembly.
EXIT	2 HOUR EXIT ENCLOSURE (vertical) (stairwell)	2 Hour Fire Barrier wall construction. No openings other than required exit doors. 1 1/2 hour door assembly.
EXIT	1 HOUR FIRE BARRIER (Occupancy and Incidental Use Areas)	1 hour Fire Barrier wall construction. 3/4 hr. rated door assembly. Fire Dampers, Wall LL, requirement for sprinkled buildings.
EXIT	2 HOUR FIRE BARRIER (Occupancy)	2 hour Fire Barrier wall construction. 1 1/2 hour rated door assembly. Fire Dampers.
EXIT	3 HOUR FIRE BARRIER (Occupancy)	3 hour Fire Barrier wall construction. 3 hour rated door assembly. Fire Dampers.
EXIT	4 HOUR FIRE BARRIER (Occupancy)	4 hour Fire Barrier wall construction. 3 hour rated door assembly. Fire Dampers.
EXIT	2 HOUR FIRE WALL (Shading Separation)	2 hour Fire Wall construction per IRC 706. 1 1/2 hour door assembly. Fire dampers when ductwork is allowed to penetrate wall.
EXIT	3 HOUR FIRE WALL (Shading Separation)	3 hour Fire Wall construction per IRC 706. 3 hour door assembly. Fire dampers when ductwork is allowed to penetrate wall.
EXIT	4 HOUR FIRE WALL (Shading Separation)	4 hour Fire Wall construction per IRC 706. 3 hour door assembly. Fire dampers when ductwork is allowed to penetrate wall.
EXIT	1 HOUR SHaft (2 stories or more)	1 hour Fire Barrier wall construction. 1 hour door assembly. Fire-rated Dampers.
EXIT	2 HOUR SHaft (2 stories or more)	2 hour Fire Barrier wall construction. 1 1/2 hour door assembly. Fire-rated Dampers.
EXIT	SPRINKLERED INCIDENTAL FIRE RISKS	Wall construction to resist the passage of smoke from four to four to F.R. fireproofing assembly. 5/8" or minimum ceiling doors or 1/2" or minimum gables.
EXIT	FIRE PARTITIONS (dwelling unit separated 1 and 2 occupancies)	1 hour resistive rated walls. 3/4 hour rated door assembly.
EXIT	SMOKE BARRIERS 1-2 and 1-3	1 hour resistive rated walls. 20 minute rated door assembly. Smoke Compens.
EXIT	ACCUMULATED EXIT WIDTH AT REQUIRED EXIT door widths	Occupancy/Required width. Provided width.
EXIT	PUBLIC FIRE HYDRANT (show hydrant from building)	
EXIT	ROOM SEPARATION	Room Type/Occupancy Type Maximum Allowable Occupants.
EXIT	SHOW ACCUMULATED OCCUPANT LOADS FOR COMPLEX EXIT PATHS	
EXIT	OTHER SYMBOLS AS REQUIRED	

IMPORTANT - ANY DEVIATIONS FROM THIS DOCUMENT MAY RESULT IN THE DELAY OF ISSUING THE CERTIFICATE OF OCCUPANCY. CHANGES AFFECTING THIS CODE FOOTPRINT SHALL BE DOCUMENTED BY THE CONSULTANT AND APPROVED BY THE AUTHORITY HAVING JURISDICTION.

OWNER	DATE
KRFM	DATE
DFM CODE COMPLIANCE COORDINATOR	DATE

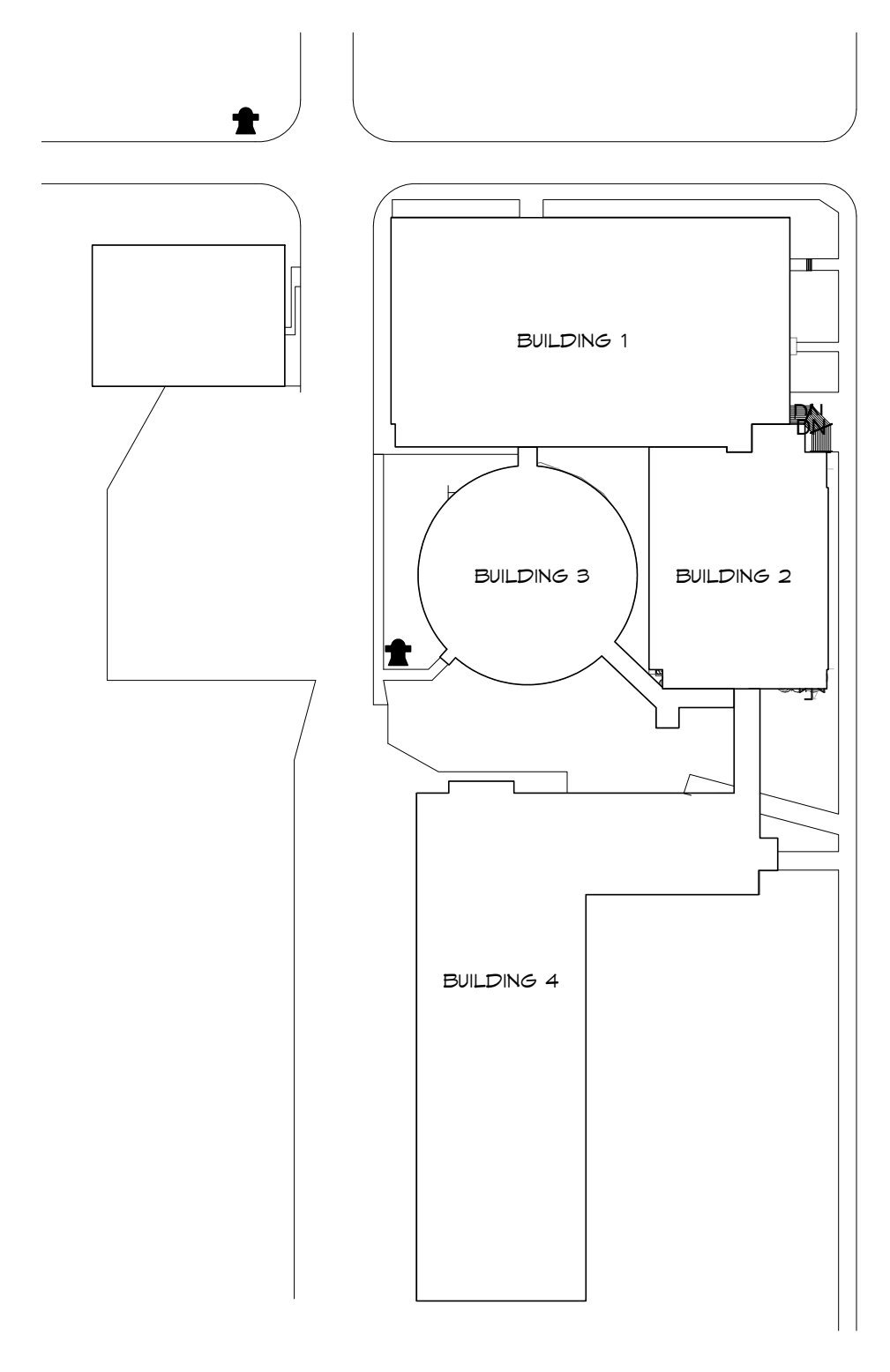

1 CODE SITE PLAN
 1" = 100'-0"
 NORTH

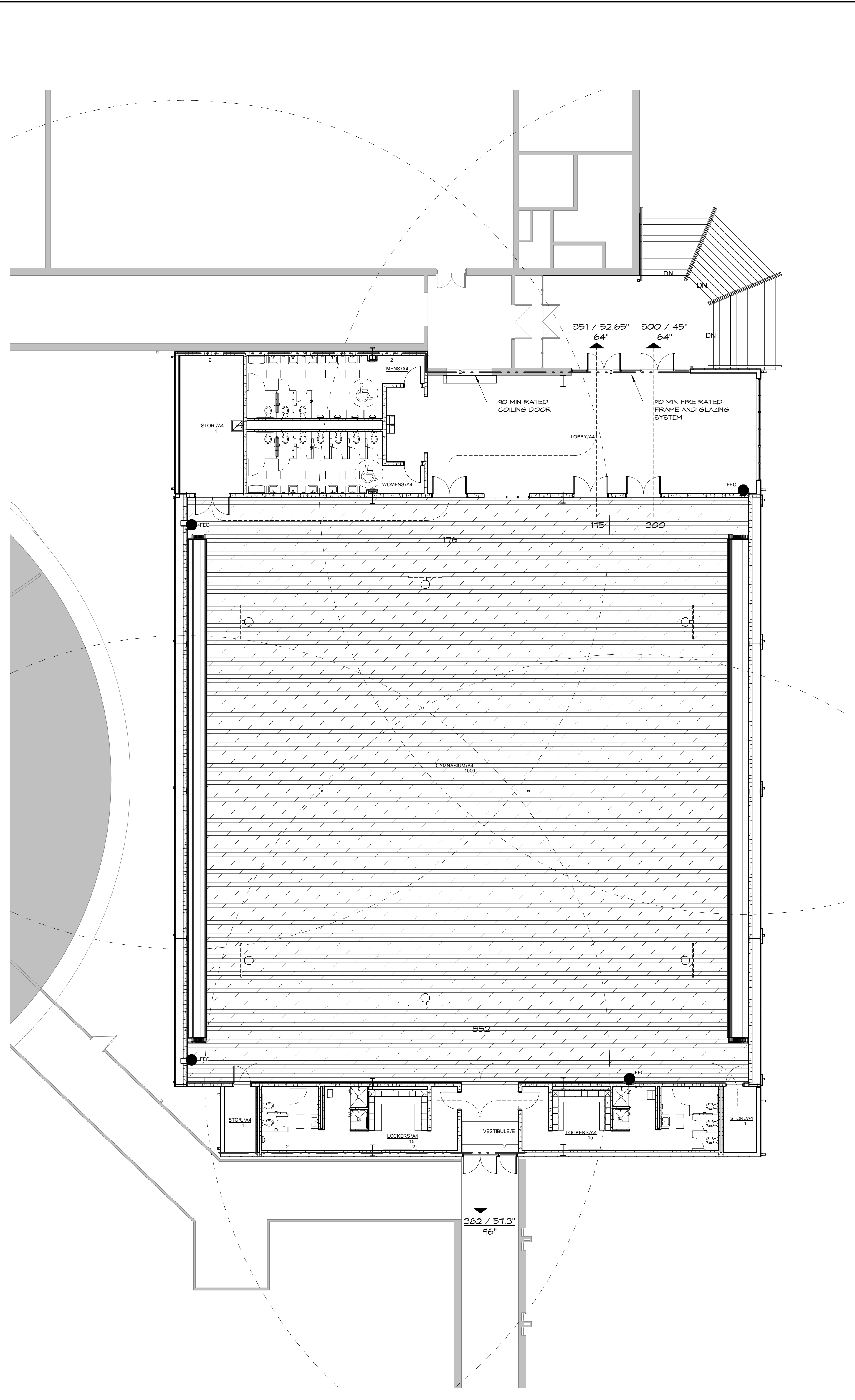

2 CODE FLOOR PLAN - MAIN LEVEL
 1" = 10'-0"
 NORTH

BUILDING KEY:

NO.	DESCRIPTION
1	EXISTING HIGH-MIDDLE SCHOOL
2	GYMNASIUM ADDITION
3	EXISTING MEDIA CENTER
4	EXISTING ELEMENTARY SCHOOL



DATE: SEPTEMBER 2, 2014
 REVISED DATE:

ROCK PORT R-2 - HIGH SCHOOL GYMNASIUM ADDITION
 ROCK PORT R2 SCHOOLS
 ROCK PORT R-2 - ROCK PORT HIGH SCHOOL - 600 S. NEBRASKA ST., ROCK PORT, MO

SHEET CONTENTS:
 CODE COMPLIANCE PLAN

HTK PROJECT NUMBER:
 1307.04-002

SHEET NUMBER:
G301
 CONTRACT DOCUMENTS