



DATE: SEPTEMBER 2, 2014  
 REVISED DATE:

**ROCK PORT R-2 - HIGH SCHOOL GYMNASIUM ADDITION**  
 ROCK PORT R2 SCHOOLS  
 ROCK PORT R2 - ROCK PORT HIGH SCHOOL - 600 S. NEBRASKA ST., ROCK PORT, MO

SHEET CONTENTS:  
 WALL SECTIONS  
 HTK PROJECT NUMBER:  
 1307.04-002  
 SHEET NUMBER:  
**A305**  
 CONTRACT DOCUMENTS

**KEYNOTES**

NOTE: Keynotes are drawn from a master list. A key may not be sequentially numbered. Dates (Ex: 204) or other info. following keynote on drawings indicates criteria for those materials/specifications which may differ from std. material specified.

030000	-1 CONCRETE STRUCTURE	09113	-1 HOLLOW METAL DOOR
	-2 CONCRETE FLOOR SLAB	-2 HOLLOW METAL FRAME	
	-3 VAPOR BARRIER	-3 FRAME ANCHOR	
	-4 REINFORCING BAR	-4 PLASTER GUARD	
	-5 REINFORCING JOINT	-5 OVERHEAD CEILING DOOR	
	-6 INTERIOR	-6 ALUMINUM ENTRANCE DOOR	
	-7 EXTERIOR	-7 ALUMINUM ENTRANCE DOOR	
	-8 SCHEDULE	-8 FRAME	
	-9 FILLER	-9 SLUICING (AS SCHEDULED)	
	-10 PRECASTED ANCHOR	-10 STEEL STUD (")	
042000	-1 FACE BRUSH	-2 STEEL STUD (")	
	-2 CONCRETE MASONRY	-3 FURRING CHANNEL	
	-3 CONCRETE MASONRY (")	-4 SYPHON BOARD (")	
	-4 WIRE REINFORCING	-5 FIRE RATED SIPHYM BOARD	
	-5 METAL TE ANCHOR	-6 GENUINE TILE BACKER	
	-6 THROUGH WALL FLASHING	-7 METAL SUSPENSION SYSTEM	
	-7 CONTROL JOINT STRIP	-8 ACoustical SEALANT	
	-8 BOND BEAM (")	-9 ACoustical INSULATION (")	
	-9 COMPRESSIBLE FILLER	-10 METAL EDGE TRIM	
	-10 KEEP HOLE/VENT	-11 AUXILIARY SUPPORT	
	-11 CAVITY DRAINAGE		
	-12 TERMINATION BAR	-13 METAL CONTROL JOINT	
	-13 STEEL BEAMS	-14 HIGH IMPACT SIPHYM BOARD	
	-14 STEEL COLUMN	-15 CONCRETE INTERIOR	
	-15 STEEL TUBE		
	-16 STEEL CHANNEL	-17 FINISHING	
	-17 STEEL JOIST	-18 ACoustical PANEL (X") (")	
	-18 JOIST EXTENDED END	-19 FIRE RATED	
	-19 JOIST - CEILING EXTENSION	-20 CEILING SUSPENSION SYSTEM	
	-20 METAL BEAMS	-21 AUXILIARY SUPPORT FRAMING	
	-21 FLEXIBLE CLOSURE STRIPS	-22 EDGE MOLD TRIM	
	-22 STEEL COMPOSITE	-23 SUPPLY SYSTEM	
	-23 DECKING	-24 PERIMETER BASE	
	-24 STRUCTURAL STEEL STUDS	-25 RESILIENT WALL BASE	
	-25 CLUSTER	-26 TACTILE WARRING SURFACE	
	-26 STEEL ANGLE	-27 RESILIENT STAR RISER	
	-27 STEEL CHANNEL	-28 RESILIENT STAR RISER	
	-28 STEEL Lintel	-29 RESILIENT STAR RISER	
	-29 STEEL TUBE	-30 RESILIENT STAR RISER	
	-30 STEEL PIPE	-31 RESILIENT STAR RISER	
	-31 STEEL PLATE	-32 RESILIENT STAR RISER	
	-32 STEEL LADDER	-33 EXTERIOR PAINT	
	-33 STEEL SCHEDULE	-34 INTERIOR PAINT	
	-34 TRUSS/GRAN	-35 INDIVIDUAL LETTER	
	-35 COVER	-36 SIGNAGE	
	-36 STEEL STAIRS	-37 TOILET COMPARTMENT	
	-37 STEEL STAIR BRACKETS	-38 URINAL SCREEN	
	-38 STEEL EMBED PLATE	-39 SHAM DISPENSER	
	-39 STEEL PIPE HANGAR	-40 TISSUE DISPENSER	
	-40 STEEL PIPE GUARDRAIL	-41 TOWEL DISPENSER	
	-41 STEEL HANDRAIL	-42 FRAMED MIRROR	
	-42 BRACKET	-43 SANITARY NAPKIN DISPENSER	
	-43 STEEL TUBE HANDRAIL	-44 SANITARY NAPKIN DISPENSER	
	-44 STEEL TUBE GUARDRAIL	-45 WASTE RECEPTACLE	
	-45 2X WOOD VALUER (")	-46 SHOWER SEAT	
	-46 2X WOOD BULGERS (")	-47 SHOWER CURTAIN ROP	
	-47 2X WOOD CONTROLS (")	-48 SHOWER CURTAIN	
	-48 PLYWOOD (")	-49 TONEL BAR	
	-49 FIB Felt	-50 SHOWER CURTAIN	
	-50 ORIENTED STRAND BOARD (")	-51 DRYER CHANGING STATION	
	-51 SHEATHING	-52 ELECTRIC HAND DRYER (ELEC)	
	-52 FIBERGLASS SHEATHING	-53 FIRE EXTINGUISHER CABINET	
	-53 FIB Felt	-54 CORRIDOR LOCKER	
	-54 ORIENTED STRAND BOARD (")	-55 ATHLETIC LOCKER	
	-55 DAMPROOFING	-56 LOCKER BENCH	
	-56 SELF-ANCHORING SHEET WATERPROOFING	-57 BASKETBALL SCAL	
	-57 FOUNDATION WALL OR UNDER SLAB	-58 VOLTAGE BALL STANDARD	
	-58 GAVITY WALL INSULATION (R-)	-59 FLOOR BLEVE	
	-59 BUILDING INSULATION - UNFACED (R-)	-60 WALL SCHEDULE PAD	
	-60 BUILDING INSULATION - FACED (R-)	-61 HAT MOVER	
	-61 SILL SEALER	-62 ROLL UP SHOWER CURTAIN	
	-62 DAMING INSULATION	-63 SOLID SURFACE PADON BALL	
	-63 SPRAY APPLIED	-64 TELESCOPING STANDS	
	-64 CELLULOSIC INSULATION	-65 PRE-INSULATED BUILDING	
	-65 SPKAY POLYURETHANE FOAM INSULATION	-66 COLUM	
	-66 SHEET METAL FLASHING AND COUNTERFLASHING	-67 SET	
	-67 PRE-FINISHED ROOF	-68 PRE-FINISHED METAL PANEL (")	
	-68 EDGE	-69 INSULATED	
	-69 PRE-FINISHED COPING	-70 PRE-FINISHED ROOF PANEL	
	-70 SHEET METAL RISLET	-71 (") (")	
	-71 SHEET METAL GUTTER	-72 PRE-FINISHED METAL GUTTER	
	-72 SHEET METAL DOWNSPOUT	-73 PRE-FINISHED METAL SOFFIT PANEL	
	-73 PRE-FINISHED METAL SOFFIT PANEL	-74 METAL PANEL CLOSURE	
	-74 SHEET METAL SCUPPER	-75 BASE ANGLE	
	-75 JOINT FILLER	-76 FRAMED OPENING HEADER OR JAMB CHANNEL	
	-76 WHERE REQUIRED	-77 PRE-FINISHED INT. HTL. WALL DOWNSPOUT	
	-77 GASKET	-78 PRE-FINISHED PERFORATED PANEL	
	-78 DRAINAGE ROD	-79 INT. HTL. SOFFIT PANEL	
	-79 EXPANSION CONTROL	-80 EXTERIOR FILL	
		-81 INTERIOR FILL	
		-82 GRANULAR DRAINAGE	
		-83 DRAINAGE BACKFILL	
		-84 SUBBASE COURSE	
		-85 SEPARATION GEOTEXTILE	
		-86 CONCRETE PAVING	
		-87 CONCRETE PAVING JOINT SEALANTS	
		-88 TURFGRASS	

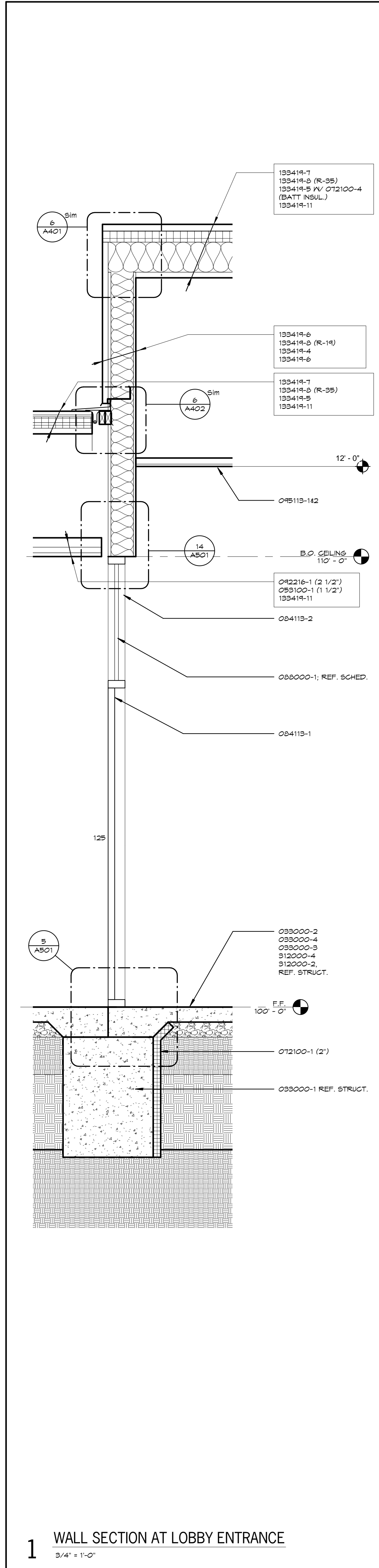

**1 WALL SECTION AT LOBBY ENTRANCE**  
 3/4" = 1'-0"

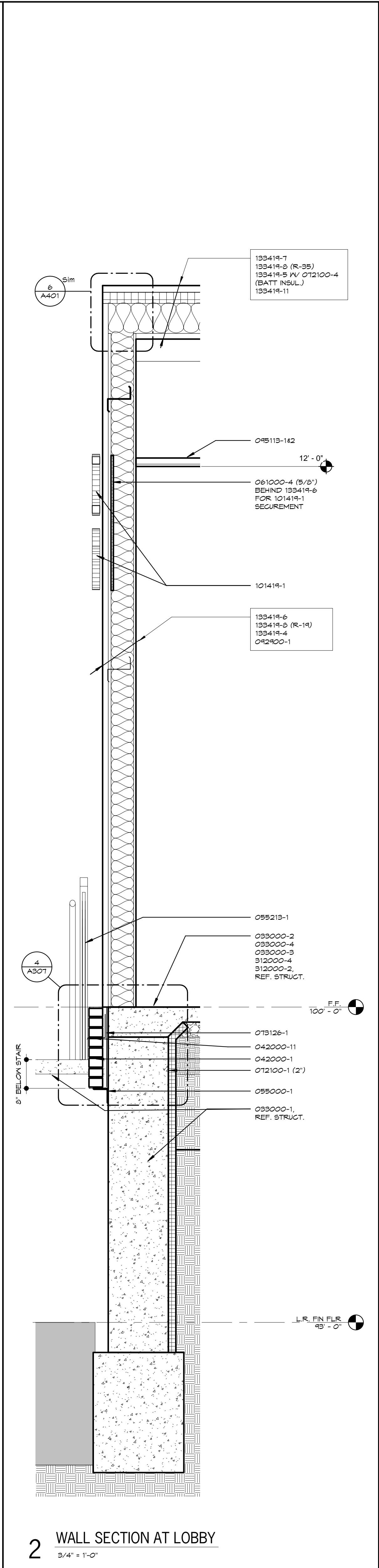

**2 WALL SECTION AT LOBBY**  
 3/4" = 1'-0"

NOTE: REFER TO STRUCTURAL DRAWINGS FOR REINFORCING STEEL IN EXTERIOR WALLS AND CONCRETE NOT SHOWN

NOTE: REFER TO ALL DETAILS (DETAILS LOCATED ON THIS SHEET, PRECEDING SHEETS AND FOLLOWING SHEETS) FOR APPLICABLE NOTES NOT SHOWN

NOTE: REFER TO ALL SECTIONS (SECTIONS LOCATED ON THIS SHEET, PRECEDING SHEETS AND FOLLOWING SHEETS) FOR APPLICABLE NOTES NOT SHOWN