

2/20/2017 4:45:52 PM  
 Snyder  
 1:50  
 Y:\open\date.tbl  
 Y:\prints\drivers\Black\_Gray\_VB\BWF\unl\wshp\PDF.plt:c1:5

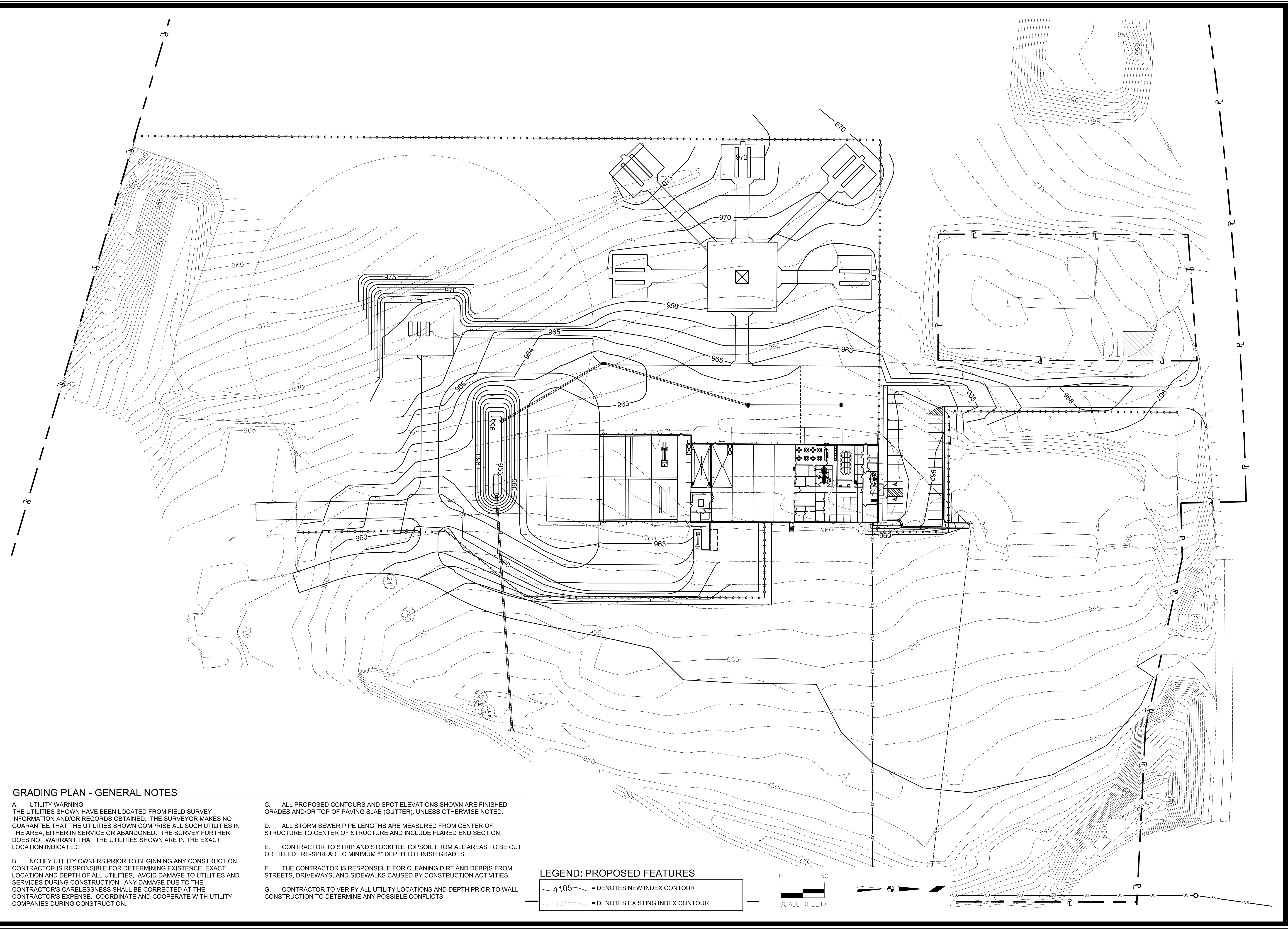

**GRADING PLAN - GENERAL NOTES**

- A. UTILITY WARNING: THE UTILITIES SHOWN HAVE BEEN LOCATED FROM FIELD SURVEY INFORMATION AND/OR RECORDS OBTAINED. THE SURVEYOR MAKES NO GUARANTEE THAT THE UTILITIES SHOWN COMPRISE ALL SUCH UTILITIES IN THE AREA, EITHER IN SERVICE OR ABANDONED. THE SURVEY FURTHER DOES NOT WARRANT THAT THE UTILITIES SHOWN ARE IN THE EXACT LOCATION INDICATED.
- B. NOTIFY UTILITY OWNERS PRIOR TO BEGINNING ANY CONSTRUCTION. CONTRACTOR IS RESPONSIBLE FOR DETERMINING EXISTENCE, EXACT LOCATION AND DEPTH OF ALL UTILITIES. AVOID DAMAGE TO UTILITIES AND SERVICES DURING CONSTRUCTION. ANY DAMAGE DUE TO THE CONTRACTOR'S CARELESSNESS SHALL BE CORRECTED AT THE CONTRACTOR'S EXPENSE. COORDINATE AND COOPERATE WITH UTILITY COMPANIES DURING CONSTRUCTION.
- C. ALL PROPOSED CONTOURS AND SPOT ELEVATIONS SHOWN ARE FINISHED GRADES AND/OR TOP OF PAVING SLAB (GUTTER), UNLESS OTHERWISE NOTED.
- D. ALL STORM SEWER PIPE LENGTHS ARE MEASURED FROM CENTER OF STRUCTURE TO CENTER OF STRUCTURE AND INCLUDE FLARED END SECTION.
- E. CONTRACTOR TO STRIP AND STOCKPILE TOPSOIL FROM ALL AREAS TO BE CUT OR FILLED. RE-SPREAD TO MINIMUM 8" DEPTH TO FINISH GRADES.
- F. THE CONTRACTOR IS RESPONSIBLE FOR CLEANING DIRT AND DEBRIS FROM STREETS, DRIVEWAYS, AND SIDEWALKS CAUSED BY CONSTRUCTION ACTIVITIES.
- G. CONTRACTOR TO VERIFY ALL UTILITY LOCATIONS AND DEPTH PRIOR TO WALL CONSTRUCTION TO DETERMINE ANY POSSIBLE CONFLICTS.

**LEGEND: PROPOSED FEATURES**

	= DENOTES NEW INDEX CONTOUR
	= DENOTES EXISTING INDEX CONTOUR

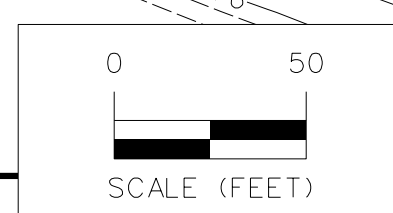

**ALTEC DESIGN ASSURANCE**

**GRADING PLAN**

**SNYDER & ASSOCIATES**  
ENGINEERS & PLANNERS, INC.

SAINT JOSEPH, MISSOURI  
802 FRANCIS STREET  
ST. JOSEPH, MO 64501  
816-364-5222

212 N. BUCHANAN  
MARYVILLE, MO 64468  
660-582-8888

MARK	REVISION	DATE	BY
Engineer: SD	Checked By: AM	Scale: 1" = 50'	
Technician: DB	Date: 01/17	Field Bk:	

Snyder & Associates Engineers & Planners, Inc.  
Missouri State Certificate of Authority #200608544