

Y:\open\date.tbl
 Y:\prints\drivers\Black_Gray_VB\SWP\altec\1161183_C2.7_StormSewerPlan.dgn
 2/20/2017 4:45:57 PM
 Snyder 1:50
 50
 K:\2016 Projects\1161183 - Altec Design Assurance\Coord\1161183_C2.7_StormSewerPlan.dgn

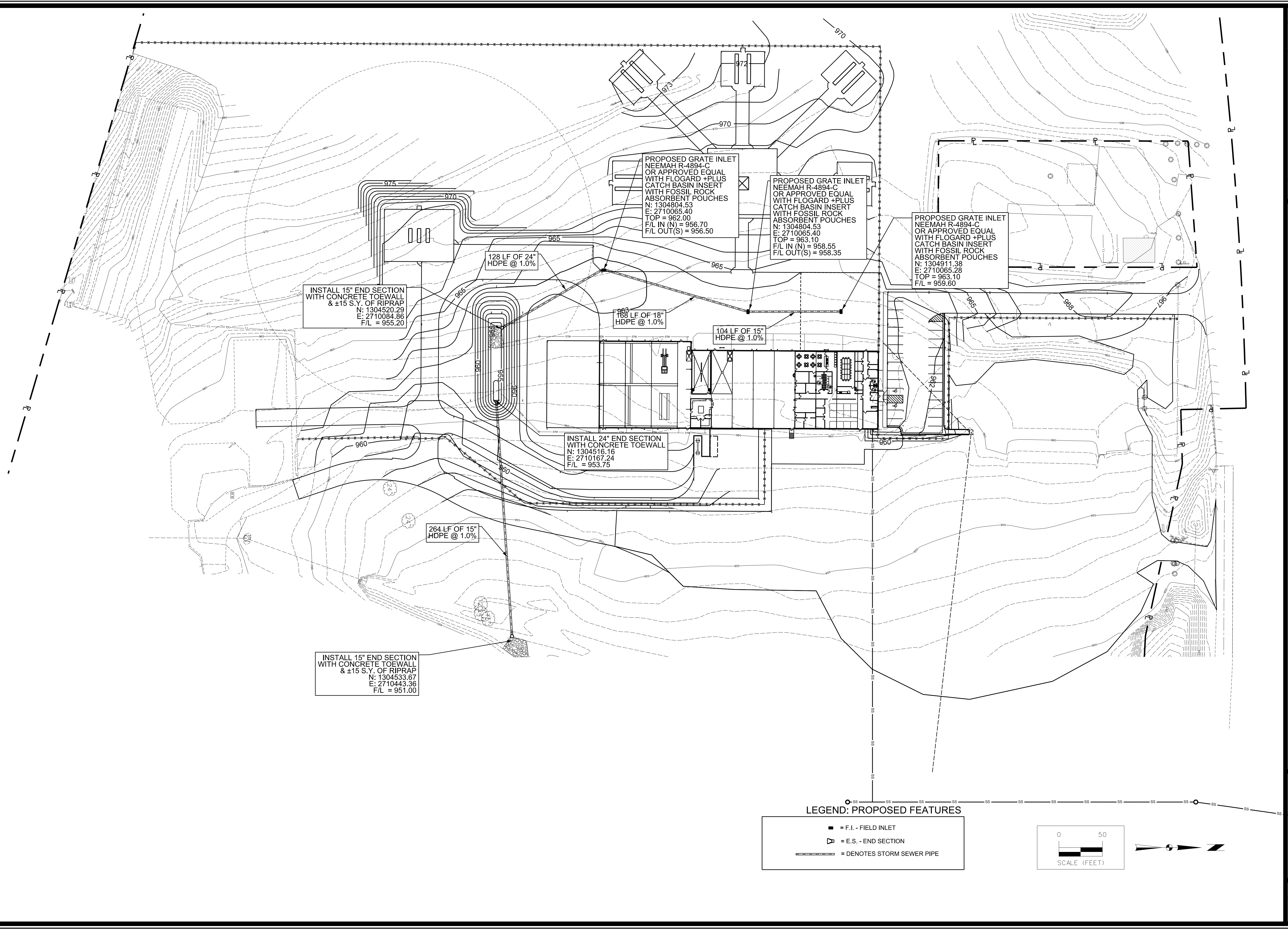

PROPOSED GRATE INLET
 NEEMAH R-4894-C
 OR APPROVED EQUAL
 WITH FLOGARD +PLUS
 CATCH BASIN INSERT
 WITH FOSSIL ROCK
 ABSORBENT POUCHES
 N: 1304804.53
 E: 2710065.40
 TOP = 962.00
 F/L IN (N) = 956.70
 F/L OUT(S) = 956.50

PROPOSED GRATE INLET
 NEEMAH R-4894-C
 OR APPROVED EQUAL
 WITH FLOGARD +PLUS
 CATCH BASIN INSERT
 WITH FOSSIL ROCK
 ABSORBENT POUCHES
 N: 1304804.53
 E: 2710065.40
 TOP = 963.10
 F/L IN (N) = 958.55
 F/L OUT(S) = 958.35

PROPOSED GRATE INLET
 NEEMAH R-4894-C
 OR APPROVED EQUAL
 WITH FLOGARD +PLUS
 CATCH BASIN INSERT
 WITH FOSSIL ROCK
 ABSORBENT POUCHES
 N: 1304911.38
 E: 2710065.28
 TOP = 963.10
 F/L = 959.60

INSTALL 15" END SECTION
 WITH CONCRETE TOEWALL
 & ±15 S.Y. OF RIPRAP
 N: 1304520.29
 E: 2710084.86
 F/L = 955.20

128 LF OF 24"
 HDPE @ 1.0%

168 LF OF 18"
 HDPE @ 1.0%

104 LF OF 15"
 HDPE @ 1.0%

INSTALL 24" END SECTION
 WITH CONCRETE TOEWALL
 N: 1304516.16
 E: 2710167.24
 F/L = 953.75

264 LF OF 15"
 HDPE @ 1.0%

INSTALL 15" END SECTION
 WITH CONCRETE TOEWALL
 & ±15 S.Y. OF RIPRAP
 N: 1304533.67
 E: 2710443.36
 F/L = 951.00

LEGEND: PROPOSED FEATURES

- = F.I. - FIELD INLET
- ▽ = E.S. - END SECTION
- = DENOTES STORM SEWER PIPE

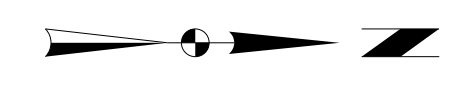
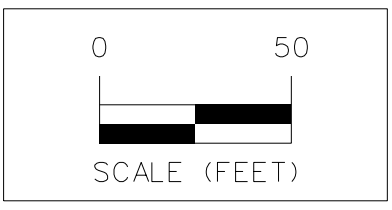

ALTEC DESIGN ASSURANCE

STORM SEWER PLAN

SNYDER & ASSOCIATES
 ENGINEERS & PLANNERS, INC.
 www.snyder-associates.com

SAINT JOSEPH, MISSOURI
 802 FRANCIS STREET
 ST. JOSEPH, MO 64501
 816-364-5222

212 N. BUCHANAN
 MARYVILLE, MO 64468
 660-582-8888

MARK	REVISION	DATE	BY

Engineer: SD	Checked By: AM	Scale: 1" = 50'	Field Bk:	Page:
Technician: DB	Date: 01/17			

Snyder & Associates Engineers & Planners, Inc.
 Missouri State Certificate of Authority #200608544

Sheet **C2.7**